



# ST. MARY'S

C O L O R A D O • 1 0 , 8 0 0 F T

St. Mary's Glacier Water and Sanitation District

Committed To Providing Clean, Safe Water for All Our Residents

Kind citizens of St. Mary's Glacier.

I hope this will serve as a weekly update to the district's attempt to make progress with frozen water lines.

As stated in last week's update, this season, we have had an unprecedented number of frozen service lines to residences. District staff is trying to ascertain whether some main lines are frozen.

We have recently learned that other communities such as Idaho Springs and the City of Leadville are having some of the same freezing issues.

I would like to thank our public for the numerous responses to our update last week. This information has been very valuable to us. I encourage these responses and would also like to hear about water lines that are flowing normally as well as frozen lines. This will assist us in determining what the next move is moving forward.

What is the district continuing to do?

The district has employed a welding service to "Hot Shot" a main line to see if it can be thawed. Please see attached updated maps of currently frozen water lines. District staff as well as the Board of Directors are reviewing these maps in hope that we can ascertain where to isolate the next Hot Shot attempt.

In the interim, district staff are available to fill water tanks/ containers for residents at the new Booster Station or at the Alice Booster Station where residents can self-serve.

Please reach out to Chris Oeland at 720-277-6585 or myself, Michael Carrano at 970-234-9761 for any assistance we can provide.

Respectfully,

Michael J. Carrano, CWP  
District Manager  
St. Mary's Glacier Water & Sanitation District

WINTERLAND

21 HOMES

23 4-11-23

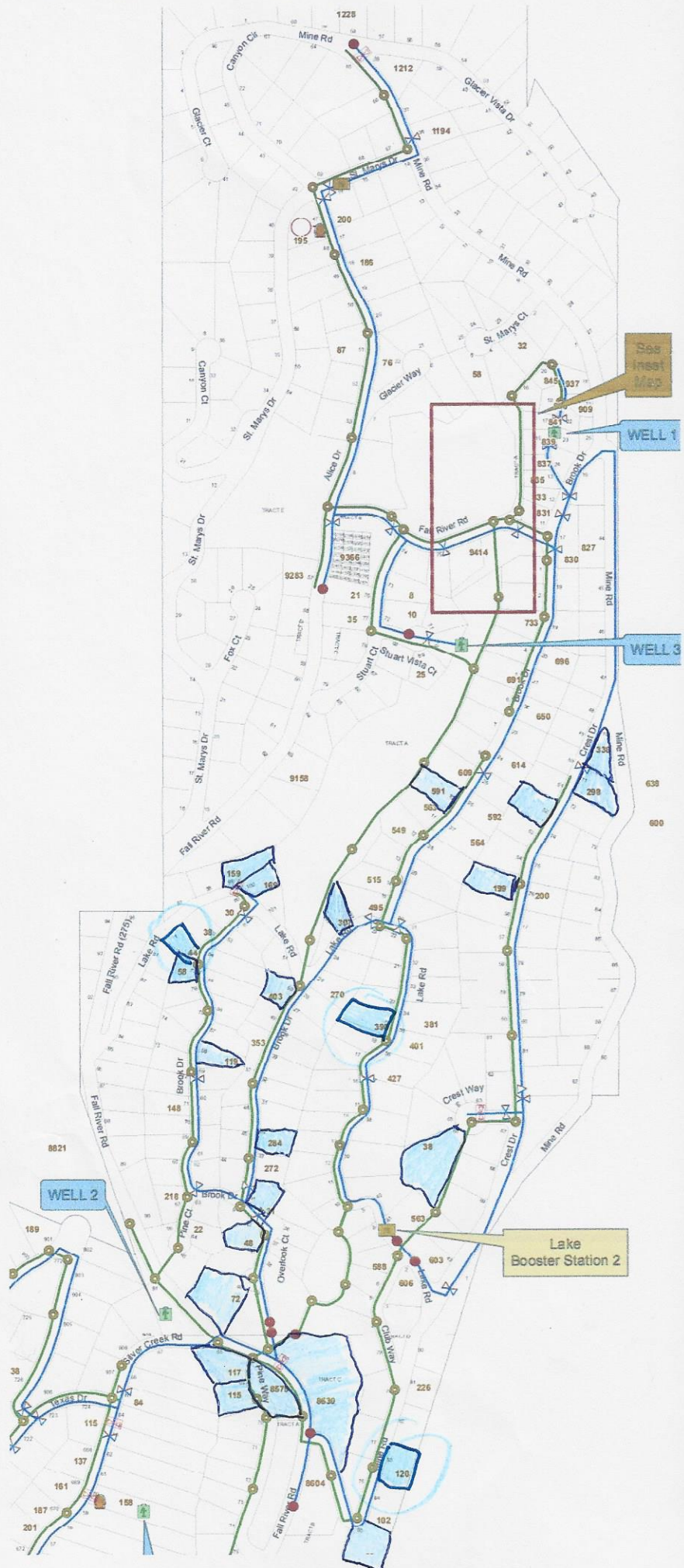

4-3-23



ALICE  
6-HOMES  
7 4-11-23

4-3-23